

Current Condition: (What useful information should we know?)

-

Planned Countermeasures to Root Causes:

Root	Countermeasure	Description	Benefits	Responsible / Support

Do – Experiment

Target Conditions: (What do we want to improve and ‘look’ like?)

-

Check: (Plans to confirm that experiments consistently deliver desired results.)

DO and CHECK

Analysis: (What analysis have you completed and/or need to complete? What Questions do we need to answer for complete understanding? Focus on determining root causes of problems.)

Follow-up: (Take appropriate actions up to and including Standard Work Implementation)

ACT/ADJUST

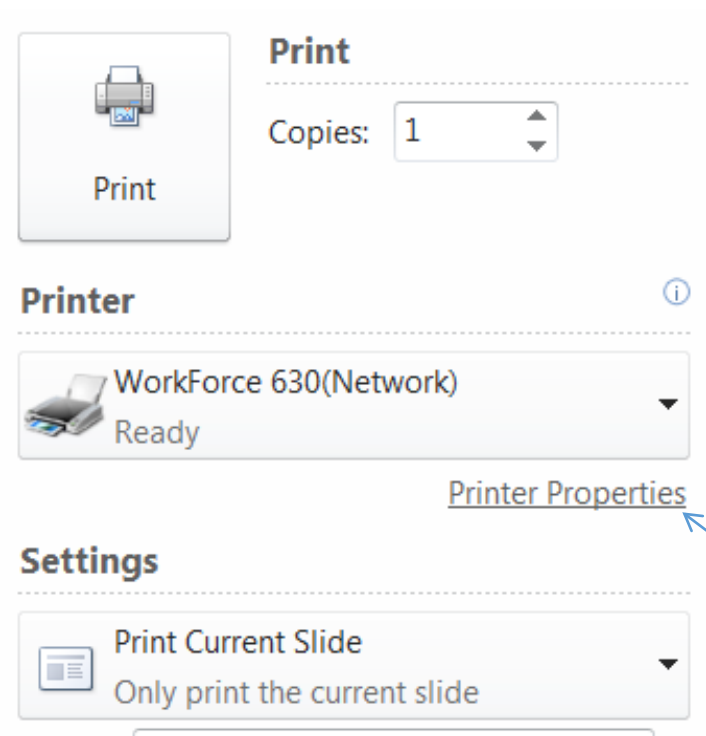

TO GET A PAPER COPY: If your printer does not have 11x17 capabilities*:

- Set the Printer to “PRINT CURRENT SLIDE”
- Use “Printer Properties”
- Go to PAGE LAYOUT tab
- Check MULTI-PAGE
- Click POSTER PRINTING
- Set to 2x1
- Now print and tape

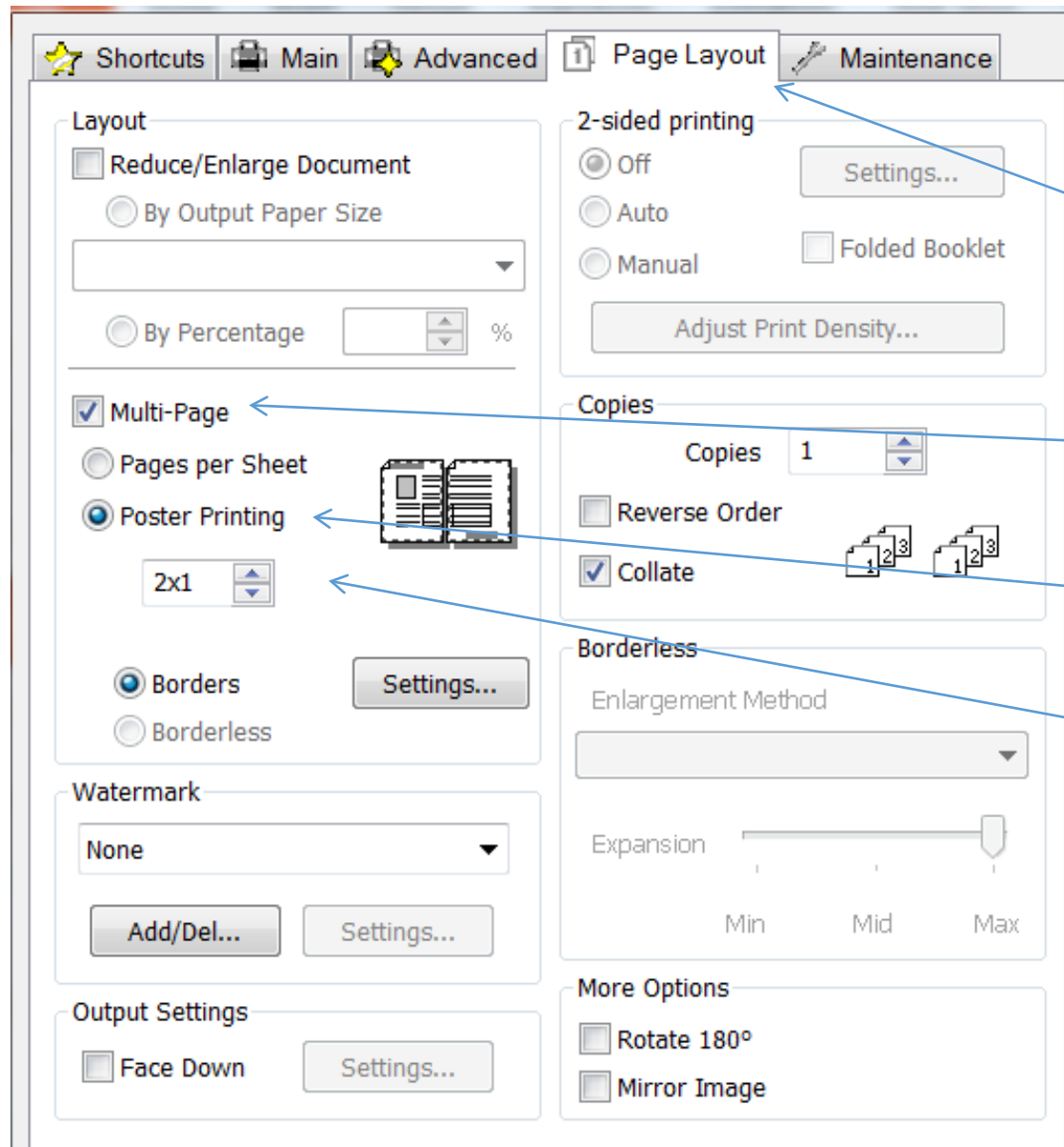

* This is an example process that works with this particular printer... variations and capabilities depend on the individual printer software.